

The background of the advertisement is a photograph of a large industrial building under construction. The structure is made of a complex network of silver-colored steel beams and columns. A large crane with a long, dark boom is positioned on the left side, lifting a heavy steel beam into place. The sky is a clear, bright blue with a few wispy white clouds. In the foreground, there is a red curved banner that contains the company's slogan. The overall scene conveys a sense of active construction and industrial strength.

ECO PLUS

PRE - ENGINEERED BUILDINGS

ECOPLUS INDUSTRIES PVT. LTD
ISO 9001 : 2015

**PASSION TO
CONSTRUCT**

ECO Group Started in 1997 in the spiritual land of Ganges in Varanasi. Later in 2012, ECO Group installed One Million Tons Per Annum State-of-art, cement manufacturing unit at Bhabua, Bihar.

In order to Integrate further with the Indian Construction Industry, the group has come up with a fully integrated Steel Plant with the capacity of 2 Lac Ton Per Annum. This plant comprises of Sponge Iron, Billets, TMT Rebar and 12 MW Power Plant at Chunar U.P.

ECO Group has already set its foot into FMCG Sector and have come up with an Edible Oil Refinery along with a Solvent Extraction Plant.

ORGANOGRAM

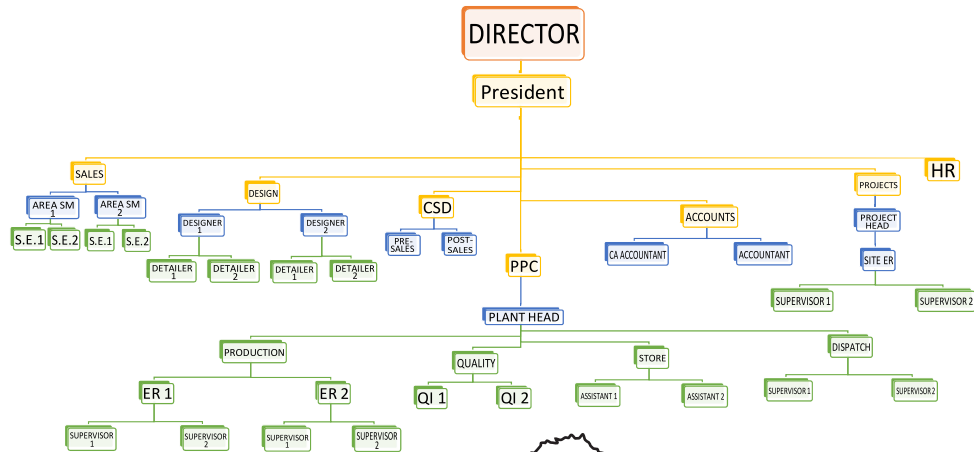

- Eco Plus Industries Pvt. Ltd**
Haryana
- Eco Infra Developers Private Limited**
Haryana
- ELATE POLYTEX Pvt. Ltd.**
UP
- ELATE INDUSTRIES Pvt. Ltd.**
UP
- ECO CEMENTS LIMITED**
Bhabhua, Bihar
- ROSEMERRY SOLVENTS PRIVATE LIMITED**
Bhabhua, Bihar
- METROPOLE VINIMAY PRIVATE LIMITED**
Bhabhua, Bihar

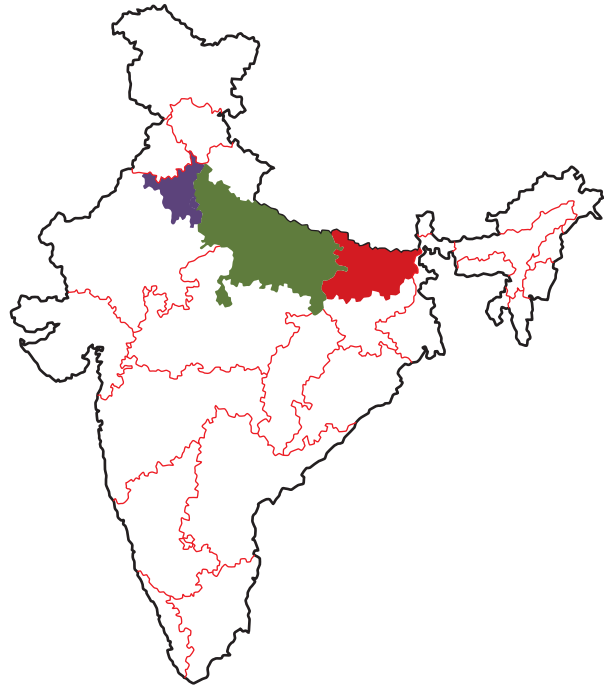

With a mission to expand into the new horizon. ECO Group started. A PRE ENGINEERING BUILDING MANUFACTURING UNIT with the ambition of "MAKE IN INDIA" campaign. Seeing the convenience and importance of facilitating readymade units for the upcoming companies and for the local manufacturers and even for the startup, ECO Group decided to provide a "Turnkey" solution that would help them come and start at once.

Ecoplus Industries Pvt. Ltd. is focussed in providing Industry infrastructure i.e. Pre-Engineered Building, Industrial Buildings and Warehouse. We are proud to have delivered challenging solutions successfully in the industry, with the help of our good and strong management of Quality and Production Team.

1. FASTER CONSTRUCTION

Being steel material, strength to weight ratio is always higher resulting speedy construction and faster delivery resulting in saving in saving of time as well as overall cost.

2. EASE OF INSTALLATION

Being lighter material, steel structure is faster to erect compared to RCC frames. Steel construction takes much reduced time at site activities, plant, material and labor causing little disruption to normal life of the community unlike wet concrete construction process.

3. STRENGTH & DURABILITY

Steel construction is always considered as best suited material for construction in adverse weather condition

4. DESIGN FLEXIBILITY

Steel construction provided highest construction flexibility in terms column free space, grid module, flexibility for future expansion without much constraints and ease modification to suit changing needs.

5. ARCHITECTURAL VERSATILITY

Being ductile material, steel can be shaped in any architectural features for aesthetic performance.

6. COST SAVING

Steel construction result in very much reduced load on foundation resulting less cost of foundation as well as time saving.

7. LARGE COLUMN FREE CONSTRUCTION

The use of steel makes possible the creation of large column free internal spaces. This helps in for open plan offices and large auditorium and concert halls.

8. EARLY OCCUPANCY

Reduced project time result in early occupancy result in economic advantage to the investor/owner.

9. MORE CARPET AREA

Steel structure occupies lesser space percentage of floor area compared to RCC columns for all structure. Brick wall and RCC construction always occupies larger space and heavy dead weight on the framing system resulting cost and time.

10. SAFER CONSTRUCTION

Steel frame construction is more suitable to withstand lateral loads caused by wind or seismic/earthquake.

11. RECYCLEABLE CONSTRUCTION

Steel material can be recycled and be used after its life cycle and is having highest recycled aspect.

12. HIGH QUALITY CONSTRUCTION

Being off site manufacturing, steel structure quality and finish can be maintained to the highest degree.

13. LOW MAINTENANCE

Steel construction requires virtually nil maintenance yearly. Fit and forget construction method which does not require periodic repair or replacement. A normal cleaning once in a year helps in longer life of the construction.

14. ENERGY EFFICIENT

By using insulation material, steel construction can be made energy efficient res

Factories | Warehouses | Workshops | Offices
Petrol Pumps | Showrooms | Aircraft hangers
Metro stations | Vehicle parking sheds
Schools | Hostels | Indoor stadium roofs | Bridges
Railway platform shelters | Outdoor stadium canopies

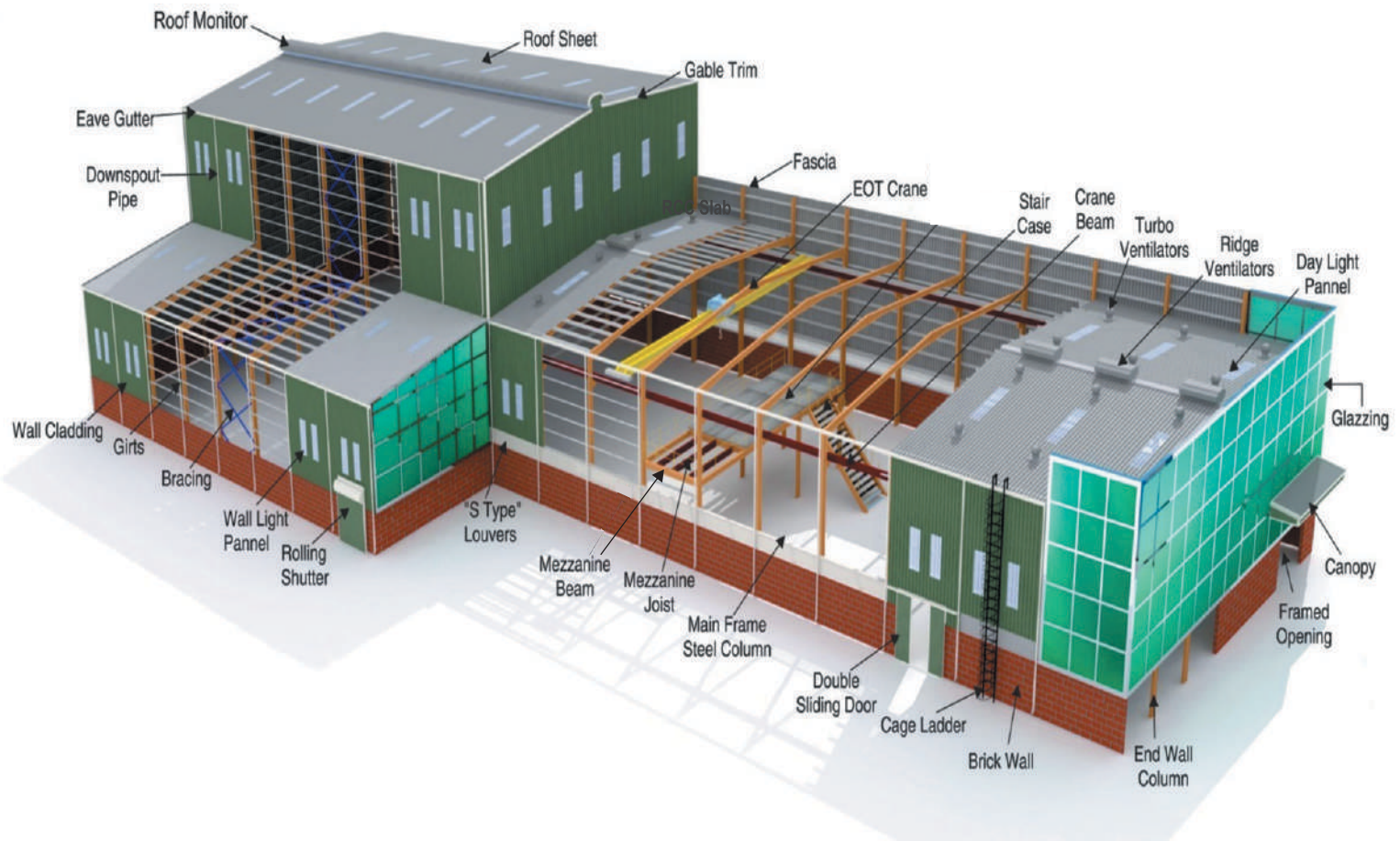

Pre engineered buildings are factory-built buildings of steel that are shipped to site and bolted together. What distinguishes them from other buildings is that the contractor also designs the building - a practice called design & build. This style of construction is ideally suited to industrial buildings and warehouses. It is cheap, very fast to erect, and can also be dismantled and moved to another site - more on that later.

Great speed is achieved because while the foundations and floor slab are being constructed, the beams and columns - the structural system - are being fabricated in the factory. Once the foundations and floor are done, the columns are shipped to the site, lifted into place by cranes, and bolted together.

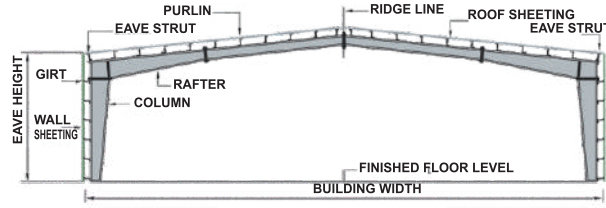

TYPICAL CROSS SECTION

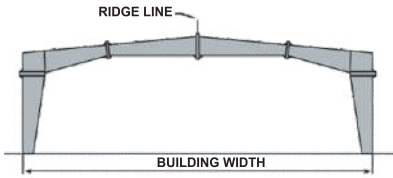

EcoClear Span (ECS)

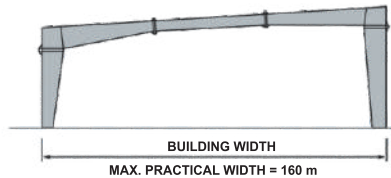

Eco Single Slope (ESS)

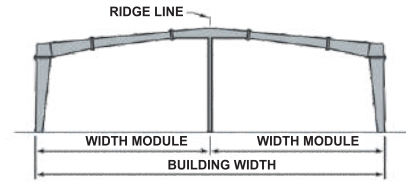

Eco Multi-Span "1" (EMS-1)

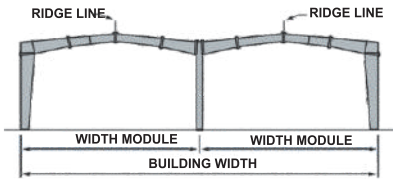

Eco Multi-Gable (EMG)

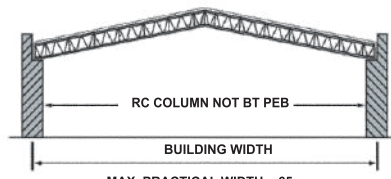

Eco Roof system (ERS)

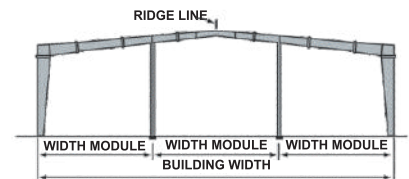

Eco Multi-Span "2" (EMS-2)

Standard Structural Details

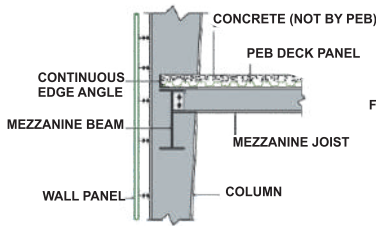

Mezzanine Joist Connection to Mezzanine Beam

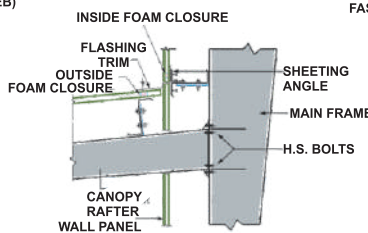

Canopy

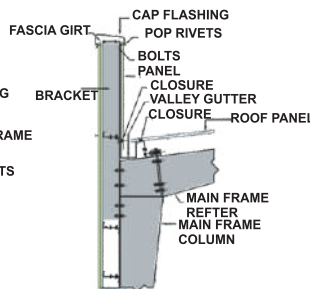

Parapet Fascia

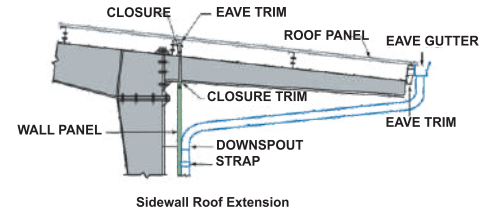

Sidewall Roof Extension

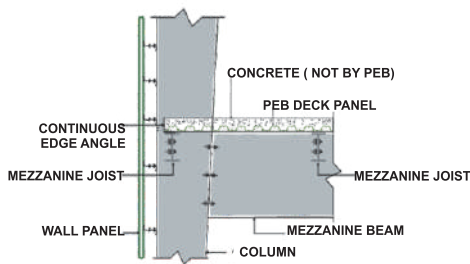

Mezzanine Beam Connection to Main Frame Column

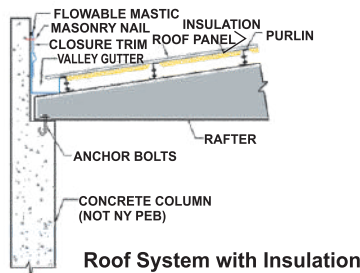

Roof System with Insulation

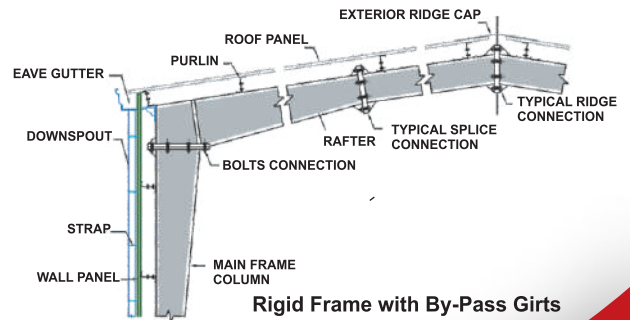

Rigid Frame with By-Pass Girts

With high precision forming and component forming machines, you can be assured about the quality & reliability of ECOPLUS PEB Metal Roofing Solutions. ECOPLUS roofing sheets are available in a range of superior and aesthetic colors for roofing and wall cladding. These roofing sheets have excellent corrosion and weather resistance quality. Sheets can be supplied in High-Rib Or Standing Seam

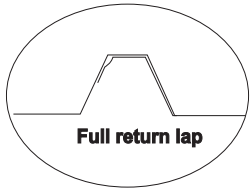
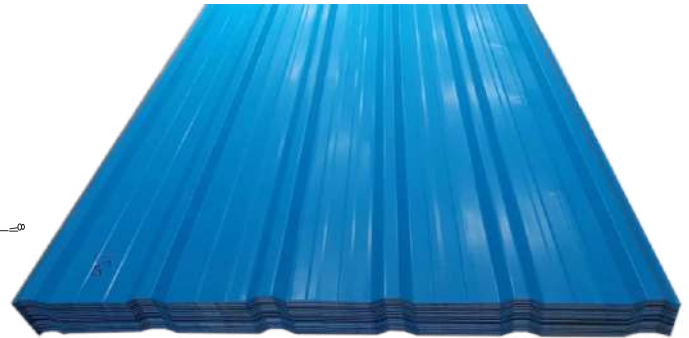
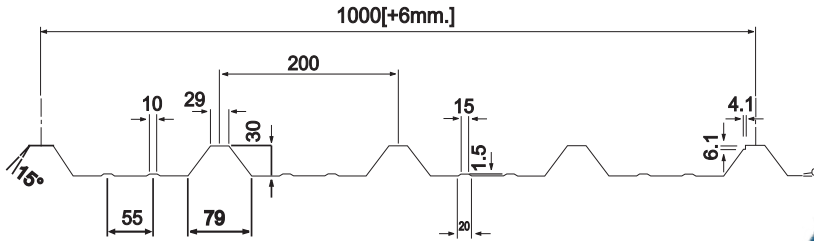

Material : 0.3mm Minimum Thickness to 0.8mm Maximum Thickness

Cover Width : 1000M±6mm
Feeding Width : 1220mm
Pre-paint Coil:Yield strength 550mpa

Turbo Ventilation System

The wind driven Air ventilators are used all over the world because of their Low Capital Costs, Easy adaptability, High air displacement capacity per ventilator and overall reliability. The air ventilator is designed to withstand a wind velocity of up to 100 kmph. It is made of Stainless Steel or Aluminium, therefore virtually maintenance free. The air ventilator weighs less than 3 Kgs. This enables flexibility and they can be installed anywhere on the roof without any structural changes.



Insulation Material

Insulated building rolls are efficient low-density insulation material made from non-combustible glasswool fibre & bonded together by thermosetting resins. The Product is easy to handle, cut & install. It is factory laminated with reinforced aluminium foil on one side. The insulation material can be Glasswool, Rockwool or Bubble wrap.





How ECO PLUS is ECO Friendly?

Save landfill space

Construction and demolition (C&D) waste makes up for a huge portion of the debris thrown into landfills. Steel-framed buildings last more compared to most conventional structures, instantly decreasing C&D waste. As steel recycles so quickly, most old steel bridges, ships, cars, pipes, cans and other products end up at recycling center as opposed to the local dump ground.

Natural Light

The design of Pre Engineered Buildings can bring in the natural light which will reduce the consumption of artificial lighting in the building saving the electricity.

Save Energy

A correctly insulated Pre Engineered steel building reduces heating and cooling expenses enormously. This significantly decreases energy cost over the lifetime of the building.

No Termite

Wood and other organic materials lure termites, wood ants, rats, mice and mold. The lumber requires to be treated with powerful chemicals to dissuade these pests. The structure and the ground enclosing it need periodic and expensive insecticide treatments. Steel is not able to hook termites and mold. Thus no chemical treatments are needed, unless the steel building is home to wooden products.

Natural Ventilation

Use of natural ventilation system in the buildings helps in proper air change and control the temprature making the inside conditions comfortable and reduce electricity consumption.

The engineering department uses the latest versions of internationally renowned industry standard 3D and 2D software for designing and detailing. We design buildings on software like STADD Pro, Autocad, Tekla etc EcoPlus Industries Pvt. Ltd. Upholds its position at the cutting edge of the industry due to its commitment to quality and customer satisfaction. Skilled structural engineers using the very latest in computerized engineering design and detailing systems permit the selection of the most economical accurate and efficient framing and cladding systems. The Design / Engineering Department is fully computerized, utilizing the latest software package to enable them to produce the most economical structures in the shortest time possible.

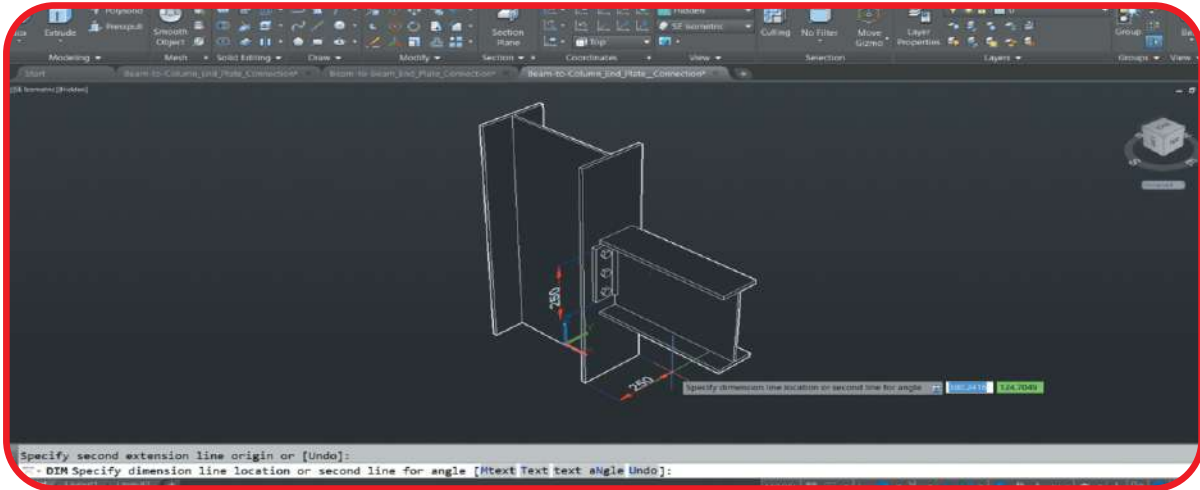

With a mission to expand into the new horizon, ECO Group started a PRE ENGINEERING BUILDING Manufacturing Unit with an ambition of "MAKE IN INDIA" campaign.

Ecoplus Industries Pvt. Ltd. is a manufacturing company, focused on Industrial infrastructure i.e. Pre-Engineered Buildings for all steel construction requirements, Industrial and Non Industrial Buildings. We are proud to have delivered challenging solutions to the industry, with the help of our good and strong Quality and Production Team.

We are having our plant at Prithla (Haryana) which is a Fully Automated Plant having a fully updated machineries like PTW (Pull Through Welding Machine), C&Z Purlin Machine, Roof and Cladding Profile machine, C.N.C. Plasma Cutting Machine, Arc Welding Machine etc.



LIST OF MACHINERY

1. CNC Plasma (200 Amp Power Source)
2. Automatic Pull thru SAW Welding Machine with O2 Power source
3. H-BEAM Tack Welding M/C
4. Compressor : For Painting
5. Shearing Machine: Cutting Bed Length 03 Mtrs.
6. Automatic Iron Worker
7. Chaser Machine
8. Z & C Section Purlin Machine
9. Sheeting Profiling Machine
10. Shot Blasting Machine with 50 HP compressor
11. Mig Welding Machine
12. Tack Welding Machine
13. Tack automatic machine
14. Rolling Machine
15. Heavy Drilling machine



Ranchi (Jharkhand) 20,000 (Sq. Ft)



Rajasthan 4,65,000 (Sq. Ft)



Ludhiana (Punjab) 93,000 (Sq. Ft)



Sonipat (HR) 55,000 (Sq. Ft)



Rajasthan 1,00,000 (Sq. Ft)



Bhabhua (Bihar) 50572 (Sq. ft)



Delhi 71554 (Sq. Ft)



Greater Noida (U.P.) 12,000 (Sq. Ft)



Sikandrabad (U.P.) 18,857 (Sq. Ft)



Kota Rajasthan 45000 (Sq. Ft)



Sikandrabad (UP) 2,20,079 (Sq. Ft)



Bhabhua (Bihar) 18,976 (Sq. Ft)



Yamunanagar (HR) 37200 (Sq. Ft)



Ludhiana (HR) 112000 (Sq.Ft)



Ludhiana (PB) 93000 (Sq. Ft)



Bhiwadi (RJ) 75000 (Sq. Ft)



Bharuch (GJ) 48000 (Sq. Ft)



Sonipat (HR) 1600 (Sq. Ft)



Sonipat (HR) 55000 (Sq. Ft)



Bagpat (UP) 31000 (Sq. Ft)

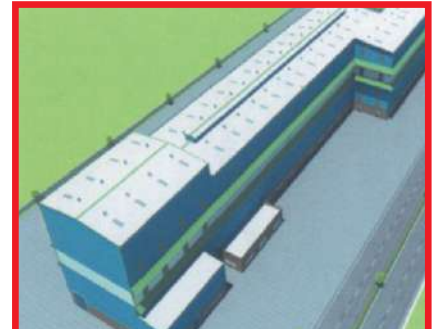

Bagpat (UP) 39000 (Sq. Ft)



Gurugram (HR) 5000 (Sq. Ft)



Gurugram (HR) 5000 (Sq. Ft)



Head Office
428, 4th Floor, SRS Tower,
Near Mewla Maharajpur
Metro Station, Faridabad - 121003

Corp. Office
4th Floor, No.2 , H.No. B-27/70, Barhar Kothi,
Durgakund, Bhelupur Varanasi - 221010 (U.P.)

Factory
Plot No. 35 & 36, Village Nangla Bhiku,
Dudhola Road, Palwal -121102 (HR.)

Contact : +91-9540500071
97173 02998, 9311772472
info@ecoplus.co.in | www.ecoplus.co.in

